

AUTOMATIC/MANUAL OUTPUT CONTROL SWITCHING

Easy Access to Auto/Manual Control Switching Parameter

- Switch between auto and manual control without entering the setup
- Clearly displays operating condition
- Prevents accidental mode switching
- Feature of all PD540 Series Digital Process & Temperature Controllers



- 1 Enter Output Value Screen
From the main operating display, press the SET/ENT key to view the PV and percent FS output.
- 2 Enter Auto/Manual Setup
Press the SET/ENT key again to view the automatic or manual control parameter.
- 3 Set Parameter to Auto or Man
Use the up and down arrow keys to set the control mode, and press SET/ENT to confirm.

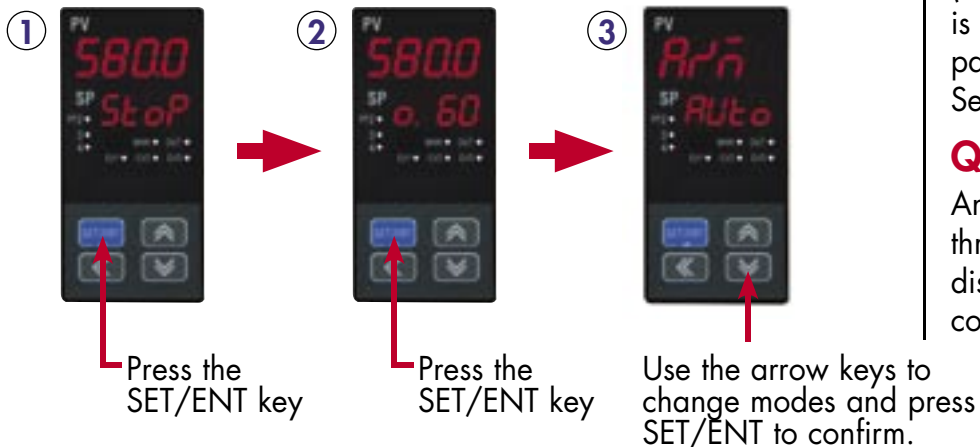

Quick Auto/Manual Switching

Switching between automatic PID and manual output level control can be done with just a few easy keystrokes, without entering any setup menus.

Easy to Setup

To setup the Nova for this application, simply set custom user screen one to display the A/M (auto/manual) parameter. To do this, set US1 in G.CTL (Control Group) to value 105. This is the D-Register value for the A/M parameter from the back of the PD540 Series Instruction Manual.

Quick Access to Other Features

Any two parameters can be accessed through the US1 and US2 custom display menus, for easy access to any commonly used parameters.